

PESHAWAR:

Deans Trade Center, UG-7 & UG-8, Opposite F.C. Headquarters, Saddar,
Peshawar. Ph: 091-5250139-40

NOWSHERA:

Office No. 1, 1st Floor, Amin Tower, Shobra Chowk, Main G.T. Road, Nowshera.
Ph: 0923-611844-46

ISLAMABAD:

Roshan Center, 78-West, 1st Floor, Jinnah Avenue, Blue Area, Islamabad.
Ph: 051-2344491-2

LAHORE:

Office No. 106, 1st Floor, Siddiq Trade Center, 72, Main Boulevard, Gulberg-II,
Lahore. Ph: 042-35817311-14 Fax: 042-35817316

FAISALABAD:

Office No. 331-332-B, First Floor, Sunrise Mall, Gate Chowk, Satiana Road,
Faisalabad. Ph: 041-111-111-160

MULTAN:

Office No. 9, 10 & 11, 2nd Floor, ChenOne Tower, Abdali Road, Multan.
Ph: 061-4546416-17-18

KARACHI:

Mezzanine Floor, Topra Plaza, Main University Road, Opposite Urdu Science
College, Gulshan-e-Iqbal, Karachi. Ph: 021-34974674-76, Fax: 021-34974667

HYDERABAD:

Shop No. 10 & 11, Garrison Complex, Main Saddar Road, Near Bombay Bakery,
Hyderabad. Ph: 0222-720151-3

OVERSEAS REPRESENTATIVES

USA & Canada: 001-9168012415, 001-9164411138

New York: 001-9178151027

United Kingdom:

London: 0044-7961233312, 0044-7504506761,
0044-7515777888, 0044-2082559999

Birmingham: 0044-7815945949

Manchester: 0044-7535631299

Denmark & Norway: 0045-31311800

Australia & New Zealand: 0061-430236500

Saudi Arabia:

AL-Riyadh: 00966-557070726

U.A.E:

Dubai: 00971-507508902, 00971-503871896,
00971-555485534

Bahrain & Qatar: 00973-33065755

Marketed by:



111-111-160

starmarketingonline.com

0336-8555816

A PROJECT OF:



Address: Hyper Mall,
Pishtakhara Chowk,
Ring Road, Dilawar Abad,
Peshawar, K.P.



1ST EVER INTERNATIONAL STANDARD
AND BIGGEST MALL OF K.P.





The Futuristic Location

Enter the fascinating world of Hyper Mall, where excellence with a touch of class meets innovation. Hyper Mall, the luxurious shopping mall is located at Peshawar's main Ring Road, near Pishtakhara Chowk. This fascinating area of Peshawar ensures a truly futuristic lifestyle for those who plan to establish a business of their own at a desirable location in Peshawar.

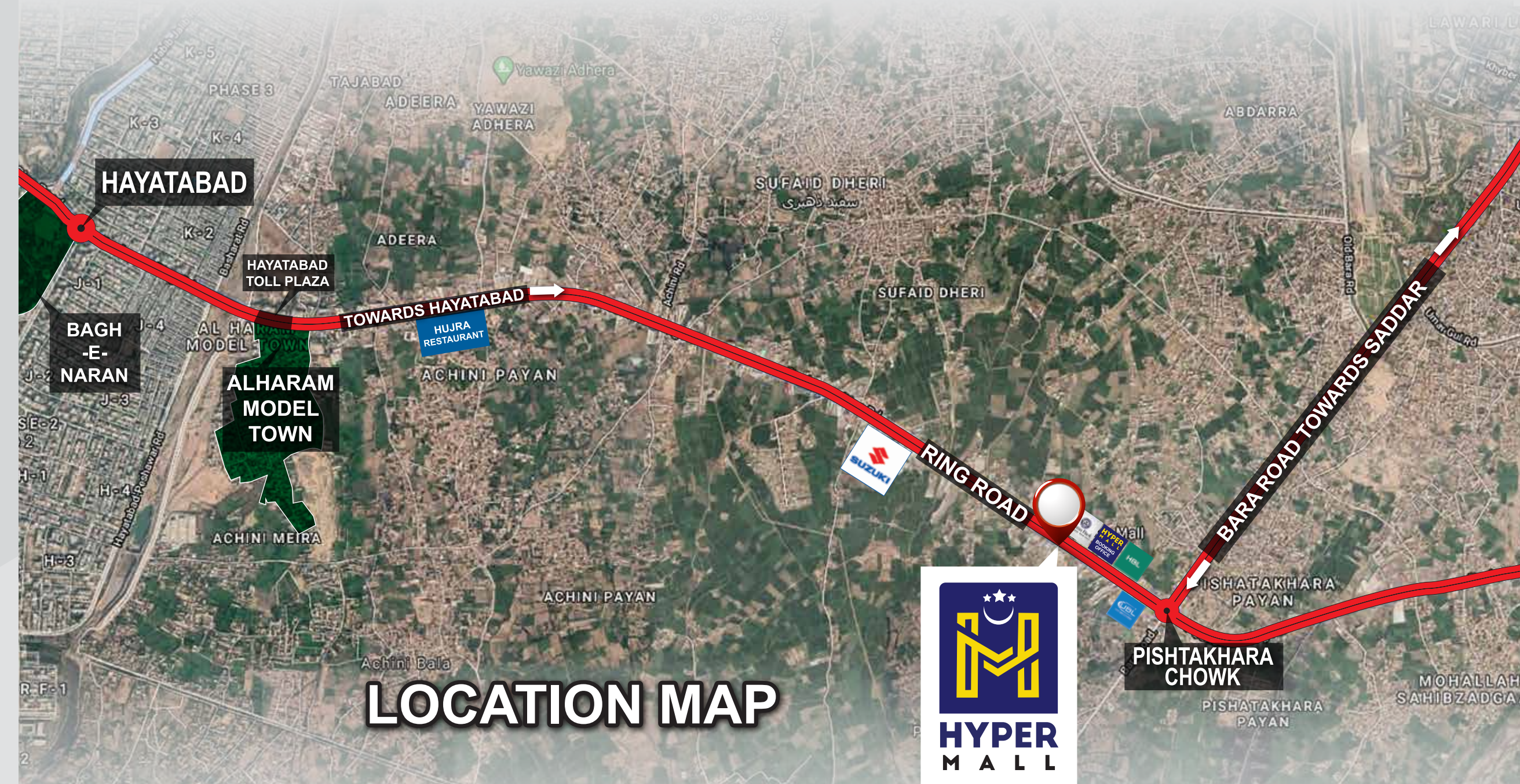

LOCATION MAP





A Truly Modern Mall

Hyper Mall; the ultra modern high rise shopping complex offering luxurious Showrooms and Shops near Pishtakhara Chowk in Peshawar. Duly approved by the Peshawar Development Authority (PDA). Hyper Mall is the only classy complex of this fascinating city where you can find the opportunity to dream start your business. Get all the advantages of the most prime location which guarantees tremendous future opportunities.



A Shopping Paradise

Home to some of the best brands, Hyper Mall offers Showrooms and Shops at different levels, all connected by modern, fast moving lifts and escalators, integrating all the floors into one shopping paradise. You can choose from spacious shops of various sizes, suitable for all types of businesses including Fashion Brands, Fabric Shops, Bridals, Footwear, Electronics, Crockery, Handbags, Cell Phones, Gifts, Jewelry, Watches and many more.





Double Height Shops

The modern Hyper Mall offers Double Height Shops and Showrooms for those who dream of setting up grand businesses at a good, spacious location where the inflow of thousands of customers is guaranteed. The amazing location of Hyper Mall ensures huge business opportunities for every shop in this luxurious Shopping Mall.



Pakistan's biggest Super Market

Hyper Mall will also have a huge Hyper Super Market, One of the Pakistan's biggest Mega Mart offering all essential items of daily use for the buyers. Classified sections of all goods, displayed scientifically for easy visibility, will give a unique shopping experience to thousands of buyers daily.





Premium Offices

Hyper Mall brings exclusively designed Offices with next level amenities, for people who want to set up their own business and experience international corporate standards. With Offices of different sizes, Hyper Mall promises to be the only modern corporate center of Peshawar to suit your needs and pockets.





Centrally Air-conditioned

Hyper Mall promises to be an enriching, extraordinary shopping destination which combines all the essentials of a great Mall; a centrally air-conditioned arena, thriving business atmosphere, wide passages, invigorating shopping and thousands of buyers. It'll be the dream location for goods and products from name-brand designers and local creative artists to fashion outlets and women's clothing.





Modern Amenities

Equipped with world class amenities, Diamond Mall brings you a whole new world of style and luxury; Hi-Tec modern elevators, wide walkways, beautiful prayer area, amazing games at the children's Play Area and a huge space dedicated for Food Court, housing popular local restaurants and international food chains where the shoppers can relax and refresh during their breaks.





Uninterrupted Power

Setting up a business in Hyper Mall means an end to the miseries caused by constant load shedding. It means uninterrupted power supply to the centrally air conditioned Mall at all times. Huge generators will provide a parallel system of 24-hour nonstop power to the entire shopping complex, attracting thousands of customers who prefer to shop in a cool, comfortable atmosphere.





Foolproof Security

Today's shopping malls need world class security so that the thousands of customers feel safe and secure. Hyper Mall is equipped with state-of-the-art security systems that include special surveillance, secure & peaceful environment, Security Guards and round the clock CCTV Network.



Double Floor Food Court

Be it a leisurely breakfast, a chat over a cup of tea with a friend or two, a casual lunch or a formal dinner, the double-floor Food Court at Hyper Mall will offer exotic food to serve your appetite. Serene and pleasing, the Food Court of international standard will be a perfect getaway to break the day for lunch or to linger over dinner.





Family Fun City

Shopping with kids can sometimes be a bit stressful. Hyper Mall has the right solution for this problem. The Play Land at Hyper Mall will be equipped with games to entertain children of all ages. Be it a toddler or a pre-teen kid, the Play Land will keep him or her busy at all times.



Triple Basement Parking (700+ Parking Slots)

A great part of the welcome that Hyper Mall renders, in addition to its prime location, is the Triple Basement Parking facility. A secure, spacious and organized parking facility is the backbone of the system that makes it a successful center of activity.

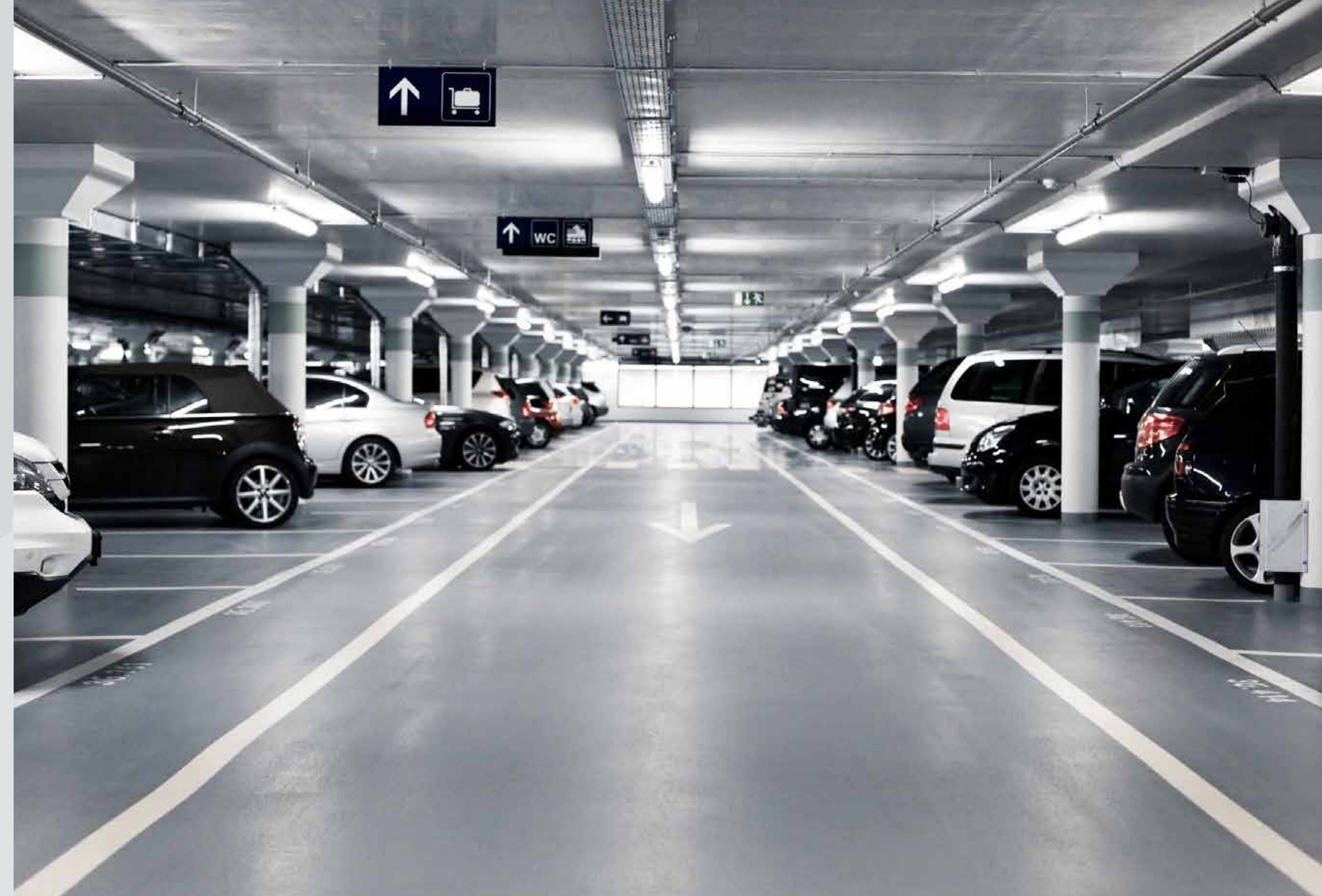



Easy Payment Schedules

You can get a unit of your choice in Hyper Mall to establish a successful business of your own. The prices are just right and the payment plans, spread over 3 years, are very easy. Special discounts are available on full payment, half payment and Star Club Card holders.



GROUND FLOOR PLAN

Sr No.	Type	No.	Area (SFT)
1	Shop Type A	14	16933
2	Shop Type B	9	8374
3	Shop Type C	6	6898
4	Core	2	3332
5	Toilets	1	889
Total (SFT)			36426
Total Floor Area (SFT)			70214

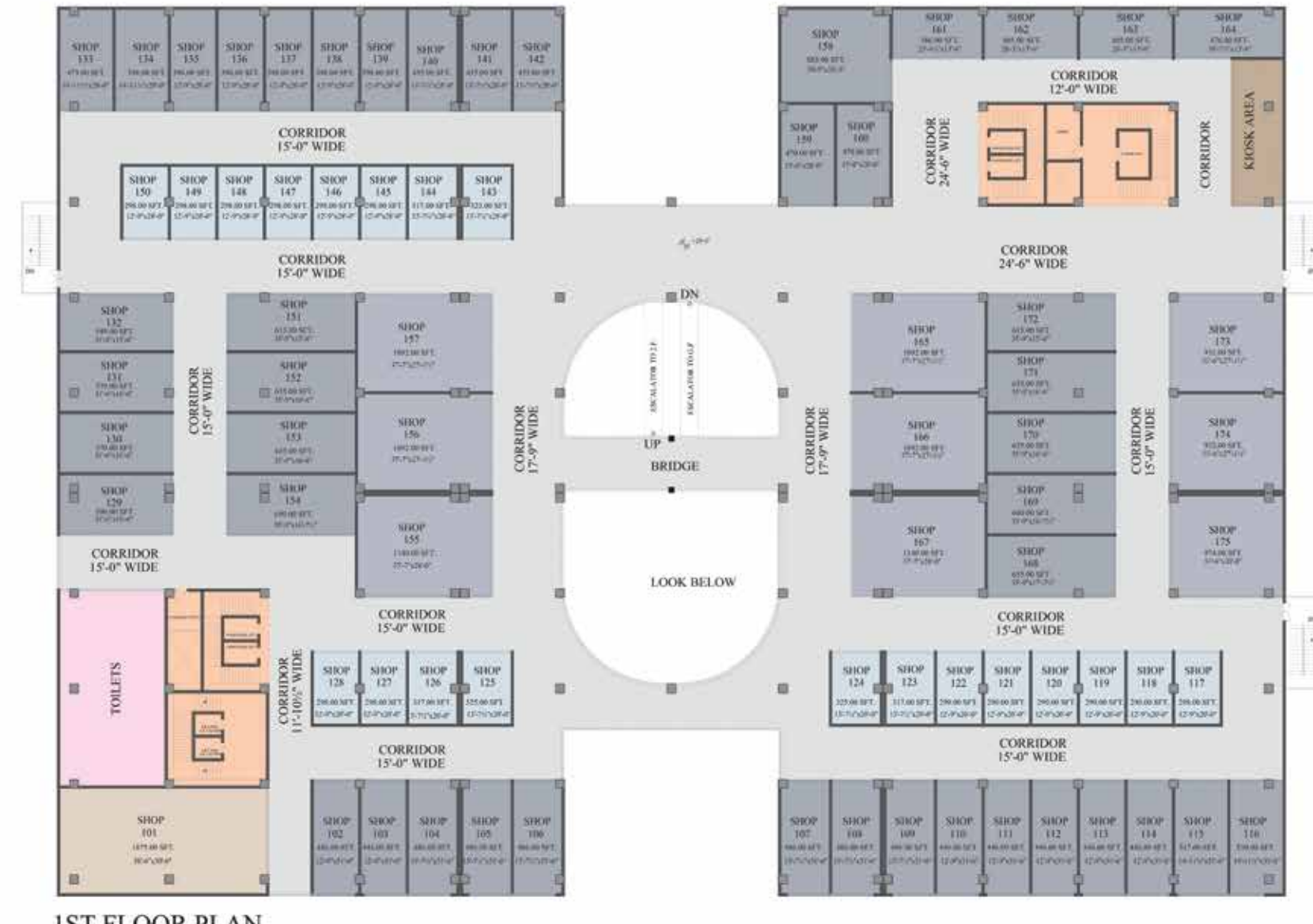

1ST FLOOR PLAN

Sr No.	Type	No.	Area (SFT)
1	Shop Type A	45	22736
2	Shop Type B	20	6058
3	Shop Type C	9	9486
4	Shop Type D	1	1875
5	Core	2	3332
6	Toilets	1	1636
7	Prayer Area	1	612
Total (SFT)			45735
Total Floor Area (SFT)			76626



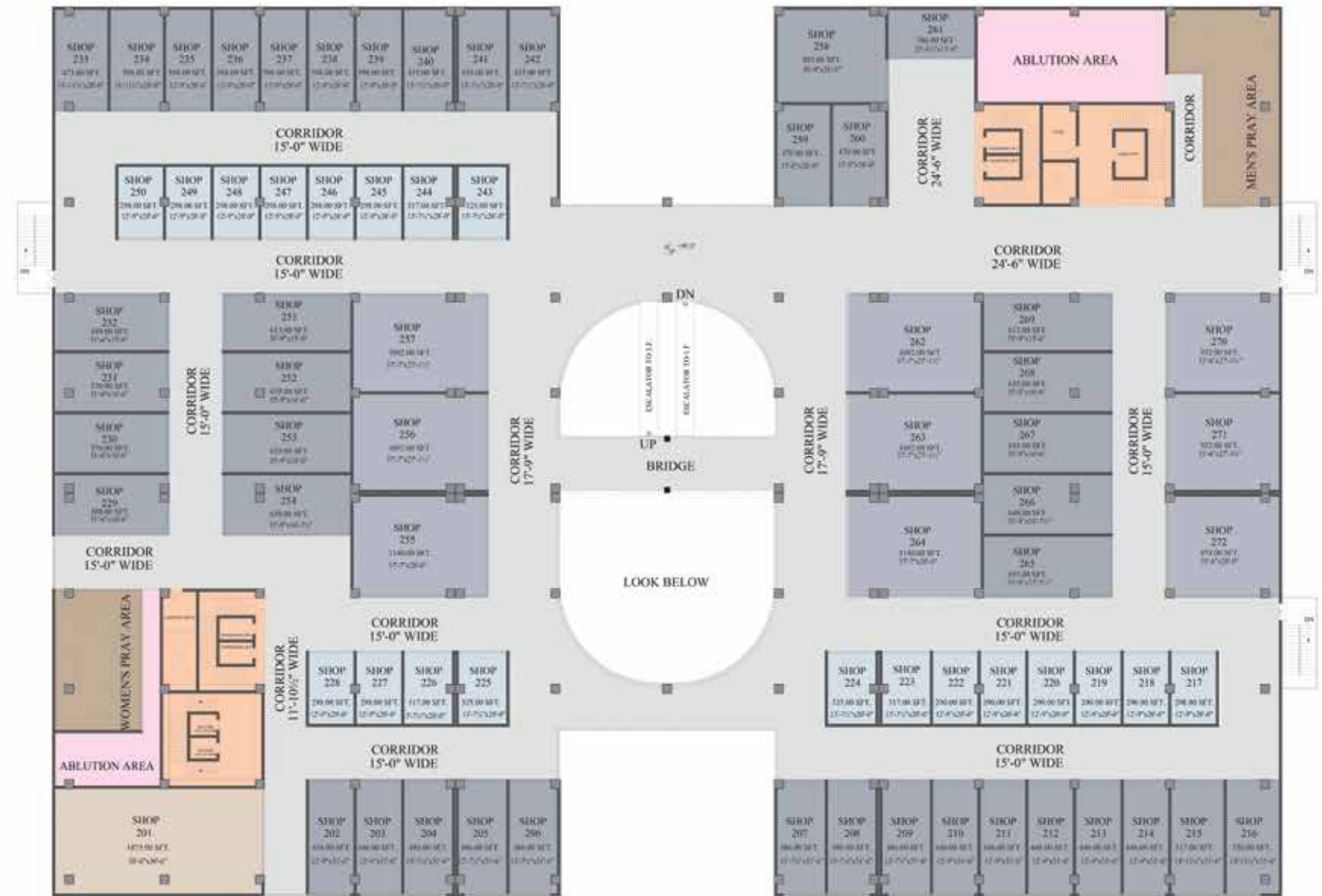

2ND FLOOR PLAN

Sr No.	Type	No.	Area [SFT]
1	Shop Type A	42	20103
2	Shop Type B	20	6058
3	Shop Type C	9	9486
4	Shop Type D	1	1875
5	Core	2	3332
6	Ablution	2	1843
7	Prayer Area	2	2280
Total [SFT]			44977
Total Floor Area [SFT]			76626

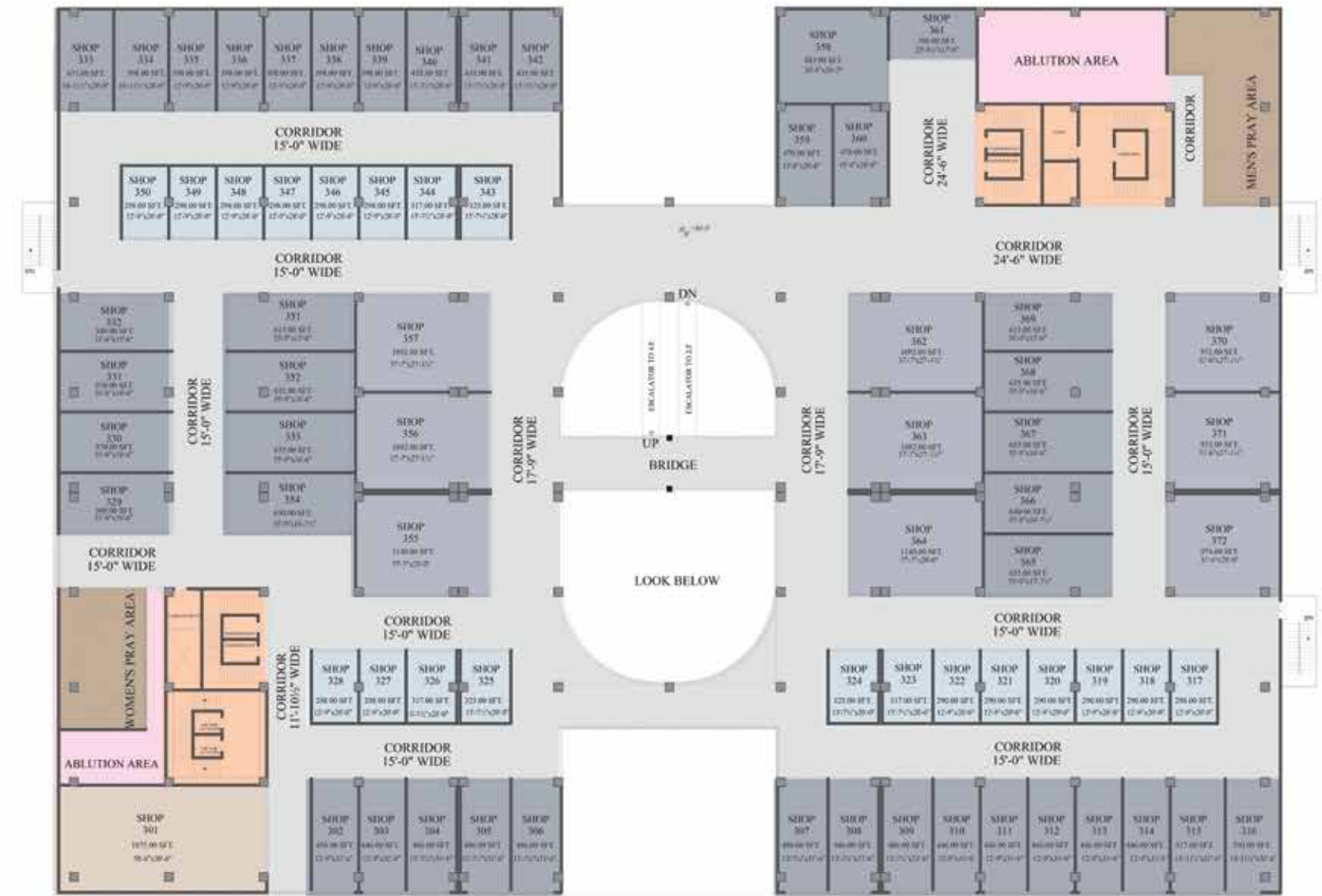

3RD FLOOR PLAN

Sr No.	Type	No.	Area [SFT]
1	Shop Type A	42	20103
2	Shop Type B	20	6058
3	Shop Type C	9	9486
4	Shop Type D	1	1875
5	Core	2	3332
6	Ablution	2	1843
7	Prayer Area	2	2280
Total [SFT]			44977
Total Floor Area [SFT]			76626



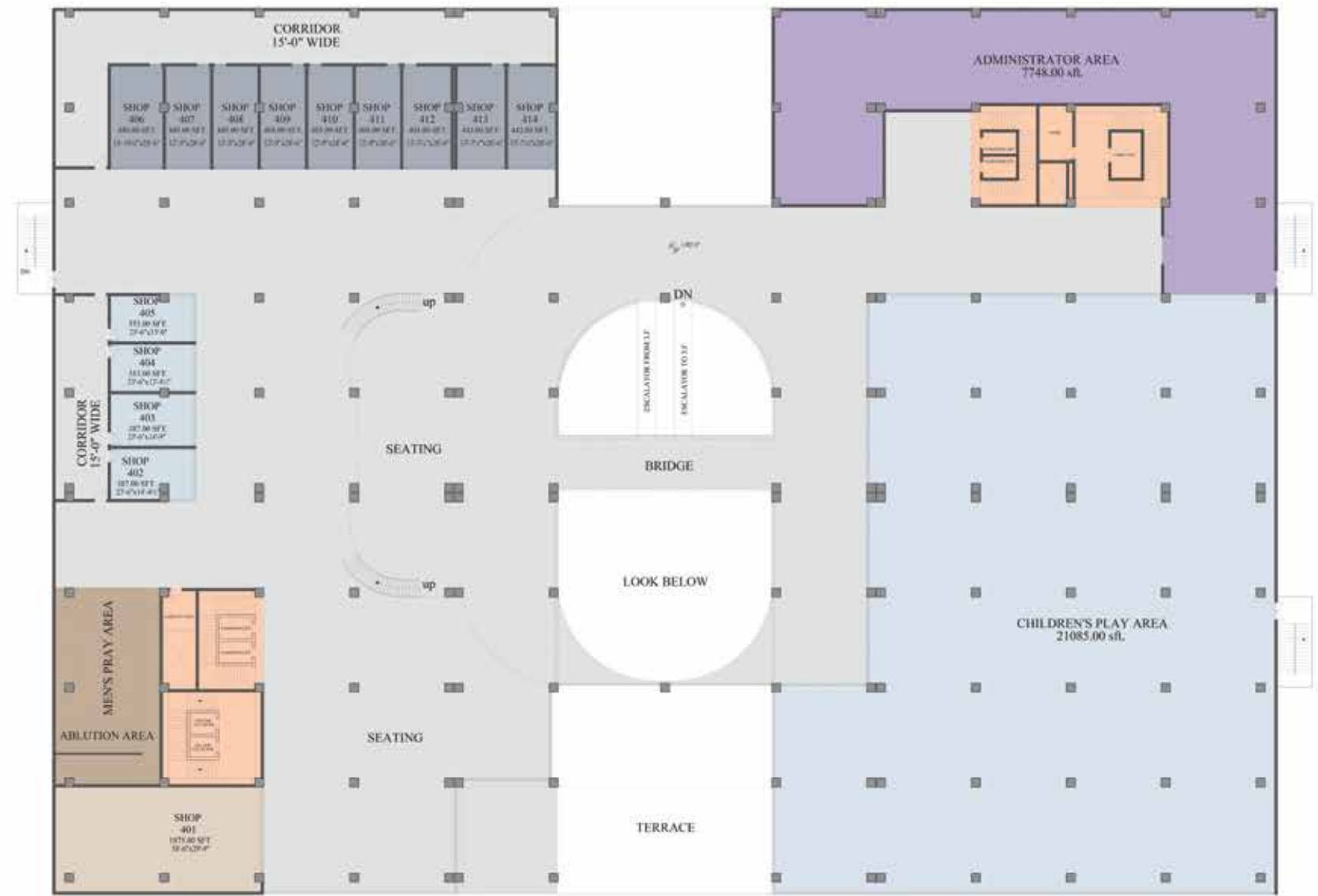

4TH FLOOR PLAN

Sr No.	Type	No.	Area (SFT)
1	Shop Type A	9	3794
2	Shop Type B	4	1480
3	Shop Type D	1	1875
4	Administration Area	1	7748
5	Children's Play Area	1	21085
6	Prayer Area (Men)	1	1658
7	Core	2	3332
Total (SFT)			40972
Total Floor Area (SFT)			77816



4TH FLOOR PLAN (MEZZANINE)

Sr No.	Type	No.	Area (SFT)
1	Shop Type A	9	3794
2	Shop Type B	4	1480
3	Shop Type D	1	1875
4	Prayer Area (Women)	1	932
5	Ablution	1	726
6	Core	2	3332
Total (SFT)			12139
Total Floor Area (SFT)			31203





5TH FLOOR PLAN

Sr No.	Type	No.	Area (SFT)
1	Office Type A	5	2863
2	Office Type B	7	11525
3	Office Type C	28	25181
4	Office Type D	4	4028
5	Core	2	3332
6	Toilets	2	3272
Total (SFT)			50201
Total Floor Area (SFT)			74869

